

BLOCK MANUFACTURING AND DISTRIBUTION LOCATIONS

LONG ISLAND, NY
 SANTA MARIA, CA
 MUSKEGON, MI

OPELIKA, AL
 PURVIS, MS
 SHREVEPORT, LA

WEST VALLEY CITY, UT
 MUSKOKA, ON, CANADA

BR Innovations

Solutions for the Tent, Rental and Event Production Industry

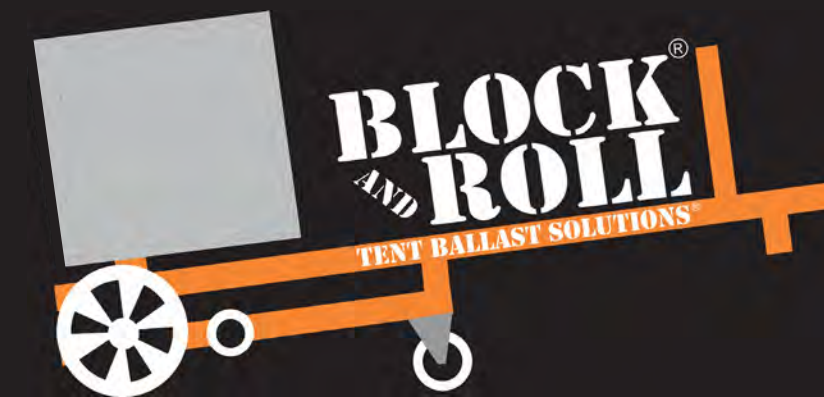

PRE MADE BLOCKS

See Back Cover for Block Distribution Locations



700lb Block



500lb Block



350lb Block



Pre Made Block



350lb Cover
Grey Trim



500lb Cover
White Trim



700lb Cover
Brown Trim

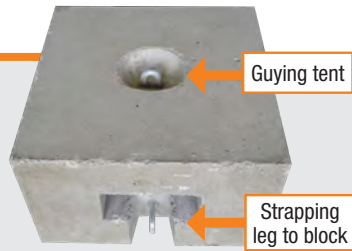

Guying tent

Strapping leg to block

BLOCK COVERS

Vinyl Block covers are available for all size blocks and block configurations. Block covers feature hemmed hole on top and side to expose tie off points. Color trim is used for identification of cover size.



RUBBER MAT

Rubber Block Mat for protecting surfaces and adding a modifier for reduction in sliding.



All our blocks are designed to also me moved with any machine with forks like the TentOx or Off Road Mover.

MULTI BLOCK 700 STEEL BLOCK FORM

Use this form to make multiple size blocks. Create perfect Block and Roll Blocks with ease. These 2 part forms assemble fast and feature pre mounted reusable rubber knockouts to hold your lifting hardware while pouring concrete. The Multi Form 700 Kit includes our revolutionary Fork Pocket and a Form divider to allow your form to make 350, 500 or 700lb blocks. Block and Roll can supply you with lifting hardware designed to work with our blocks. All steel construction primer finish. US Patent 9,868,455



FORM DIVIDER



FORK POCKET

HALF BLOCK ONLY STEEL FORM KIT

Create large 1750lb blocks with our Half Block Form Kit. This 2 pc form holds nearly a 1/2 yard of concrete to create a 40"x 20" x 29". Note 1750lb Blocks will integrate with our Big Blocks or smaller blocks if incremental weight stacking is needed. Includes 2 Rubber Knockouts to hold your lifting hardware and 2 Fork Pocket 40's to create your fork pockets. This block is movable with a forklift only.



1750lb Block



3500lb Block

BLOCK TIE OFF HARDWARE

FRONT HOOK

TOP HOOK



BLOCK STAMP

4"x8" custom made stamp with your company logo or message.



CLASSIC



MULTI BLOCK PLATES

Multi block plates allow combining small blocks to create large ballasts without the use of heavy equipment. Multi block plates feature pre-drilled bolt holes to attach your structure baseplate. Multi block plates come in 2 or 4 block models which will allow creation of up to a 5600lb ballast without a forklift and 10,500lb when using our Big Blocks. Our plates are designed to meet the IFAI Ballast Study requirements. All aluminum construction. 500lb blocks are the most common size and offer excellent versatility. US Patent 9,868,455



4 POINT HARNESS

The Block and Roll 4-Point Harness uses cam buckles and connects directly to the Block and Roll blocks with easy-to-use snap hooks. The four straps converge to one heavy-duty tie-down point for use with standard tent straps.



LEG STRAP (LOOP)

Easily secure the Block And Roll Block® to the tent post with the Block And Roll® leg strap with this endless loop design.



UNIVERSAL BLOCK PLATE

The Universal Block Plate mounts directly to your Tent structure or Truss and allows placement of most universal landscape concrete blocks. Dimensions: Block area: 34"Wx26"D Plate: 17"Wx14.5"D 4.75" H 10,500 lb Capacity

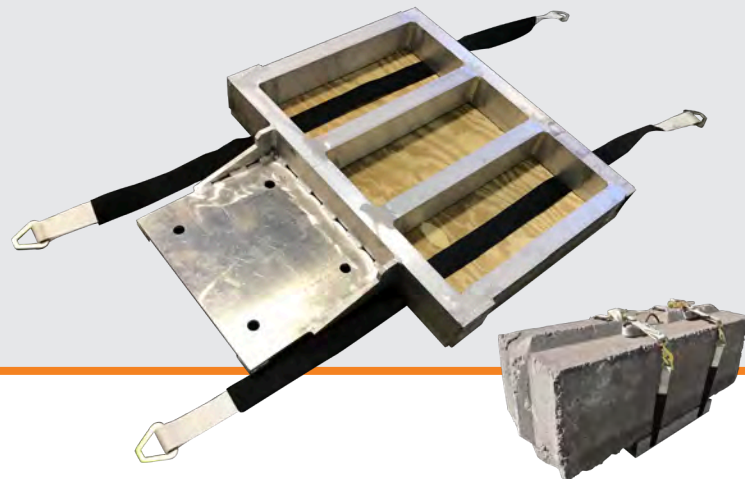

"HEAVY DUTY" STEEL BLOCK PLATES

The Heavy Duty Block Plate mounts directly to your tent structure and allows placement of our Big Blocks (3500lb, or 4 Smaller blocks stacked to desired weight. It will also work with most universal landscape concrete blocks. Includes 4 holes for your tent plate bolt pattern. Additional holes may be added for multiple tent systems. Double wide plate available for even larger structures up to 20,000 lb capacity. Includes plywood base modifier.

1" BLOCK/STAKE STRAP COMBO

The 1" block strap can be used as a standard tent strap assembly utilizing the Block And Roll® Blocks built in attachment point as well as used to secure a group of blocks using the attached d ring. Simply bundle the blocks with the 1" block strap by attaching the snap hook on the adjustable end to the added d ring on the fixed end then tighten. It's that easy! The added D ring can also be utilized with your tent stakes for versatility.

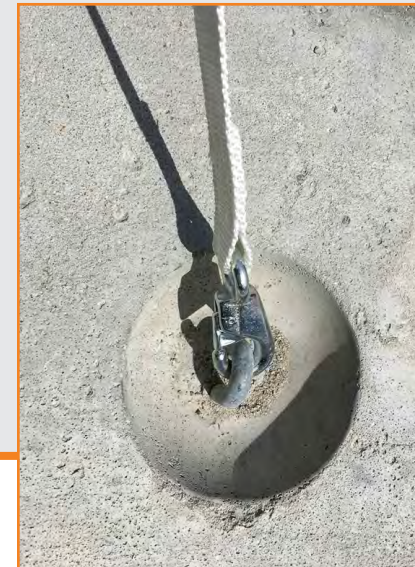

2" STRAP

The 2" block strap can be used as a standard tent strap assembly utilizing the Block And Roll® Blocks built in attachment point as well as used to secure a group of blocks using the attached d ring. Simply bundle the blocks with the 2" block strap by attaching the snap hook on the adjustable end to the added d ring on the fixed end then tighten. It's that easy! The added D ring can also be utilized with your tent stakes for versatility.



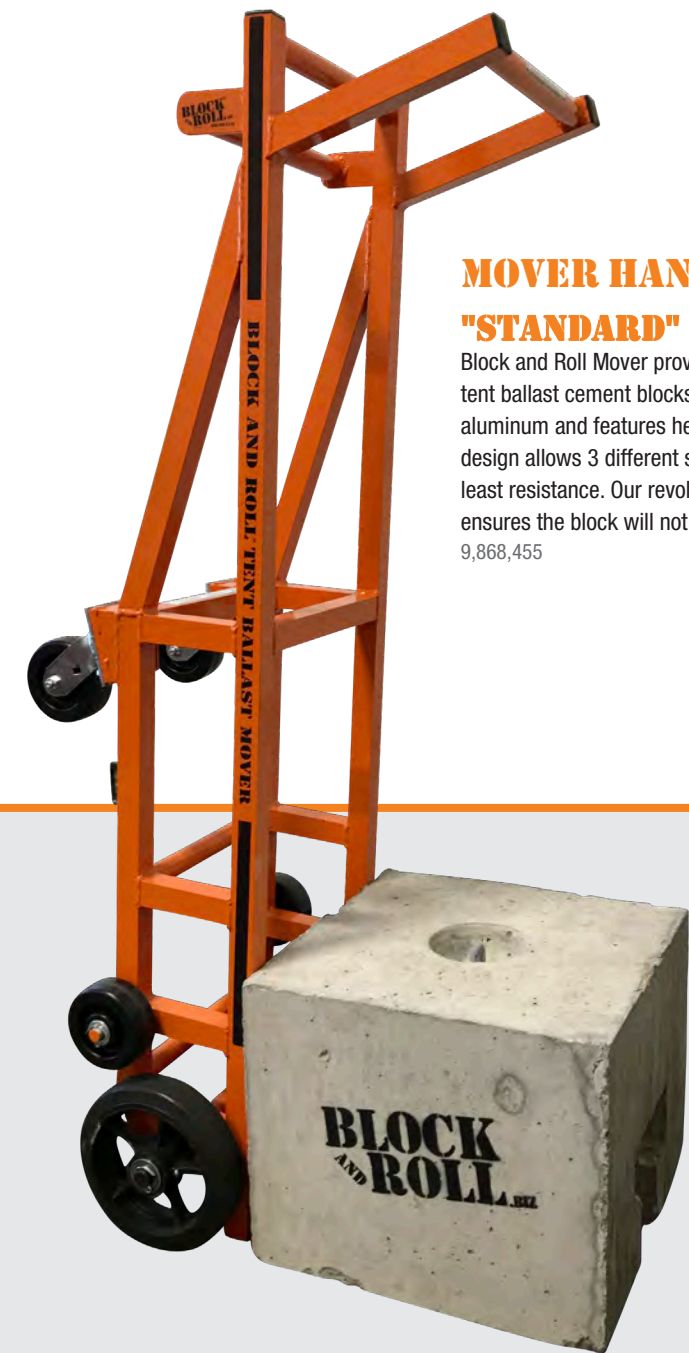

MOVER HAND CART

"STANDARD"

Block and Roll Mover provides easy moving of up to 700lb tent ballast cement blocks. The Mover is made with structural aluminum and features heavy duty wheels. This innovative design allows 3 different size blocks to be moved with the least resistance. Our revolutionary Fork Pocket design ensures the block will not fall off while in motion. Patent 9,868,455



MOVER 350

The Block and Roll 350 Mover Cart provides easy moving of 350lb Tent Ballast cement Blocks. The Mover is made with structural aluminum and features heavy duty wheels. This innovative design allows 350lb blocks to be moved with ease. Our revolutionary Fork Pocket design ensures the block will not fall off while in motion. Aluminum construction (steel axle), Black Powder coated finish. Not compatible with 500lb or 700lb blocks.



OFF ROAD MOVER

The Block and Roll Mover Off Road Edition provides easy moving of up to 700lb tent ballast cement blocks on grass and uneven surfaces. The Mover is made with structural aluminum and features 4 heavy duty foam filled all terrain wheels. This innovative design allows 3 different size blocks to be moved on grass with the least resistance. Our revolutionary Fork Pocket design ensures the block will not fall off while in motion. Aluminum construction (steel axle), Powder Coated finish. Patent 9,868,455



OFF ROAD KIT

Add our Off Road Kit to your existing Mover Cart for use on grass and uneven surfaces.
Patent Pending



OFF ROAD LOOP HANDLE CART



LOOP HANDLE CART BY GRANITE INDUSTRIES

This new Block and Roll Mover Off Road cart provides moving of up to 700lb tent ballast cement blocks on grass and uneven surfaces. The Mover is made with structural aluminum and steel. Features 4 heavy duty foam filled all terrain wheels and 10" rear wheels along with 2" wide curb wheels. Bolt together design for easy part replacement. New ergonomic loop handles. Now available as a Standard Cart option, better suited for hard surfaces such as asphalt, concrete, and indoor settings.

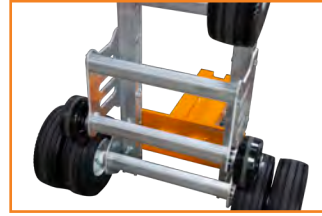

STANDARD LOOP HANDLE CART



E-MOVER 2.0 MOTORIZED BLOCK CART

Our e-Mover cart, by Granite Industries offers an electric drive motor system to effortlessly move blocks on grass and rough terrain. Perfect for long runs from the truck when a forklift or tent ox is not available or not allowed. The cart can handle up to 700lb blocks and can also haul all of your other tent gear and rental equipment.



ATV EXT ALL TERRAIN CART AND STACKER COMBO

Our Latest innovation features all terrain capabilities and stacking blocks all in one. The ATV EXT features large pneumatic tires and a foot operated pump jack. Allows for moving blocks on delicate surfaces, grass and turf fields. The ATV EXT will stack 2 blocks on top of each other to create large ballast points and is compatible with the Block And Roll Tent Ballast System. Patent 9,868,455



FRONT



BACK



EZ -STACK 350

Use this Handy accessory with your Mover Cart to stack two 350 lbs, or a 350lb block onto a 500lb block. Simply insert the EZ-Stack 350 into the forks on your Mover Cart and you're ready to stack. Patent 9,868,455



EZ -STACK 350-T

Along with stacking blocks now you can move light duty trailers with your cart.



CB STACKER

CB STACKER will let you stack blocks when a forklift is not accessible or available. Our standard model features manual hand crank winch and our CB STACKER PLUS features a 12v. battery powered winch. Patent 9,868,455
Shown with optional 12v battery powered winch.



CARRY ALL

Carry all is an add-on to your Mover Cart. This will allow you to use your Mover Cart for moving tent and rental equipment around your work site after you've moved your blocks into place. Patent 9,868,455



POLE AND BASE SYSTEM

WORKS WITH BLOCK AND ROLL® BLOCKS

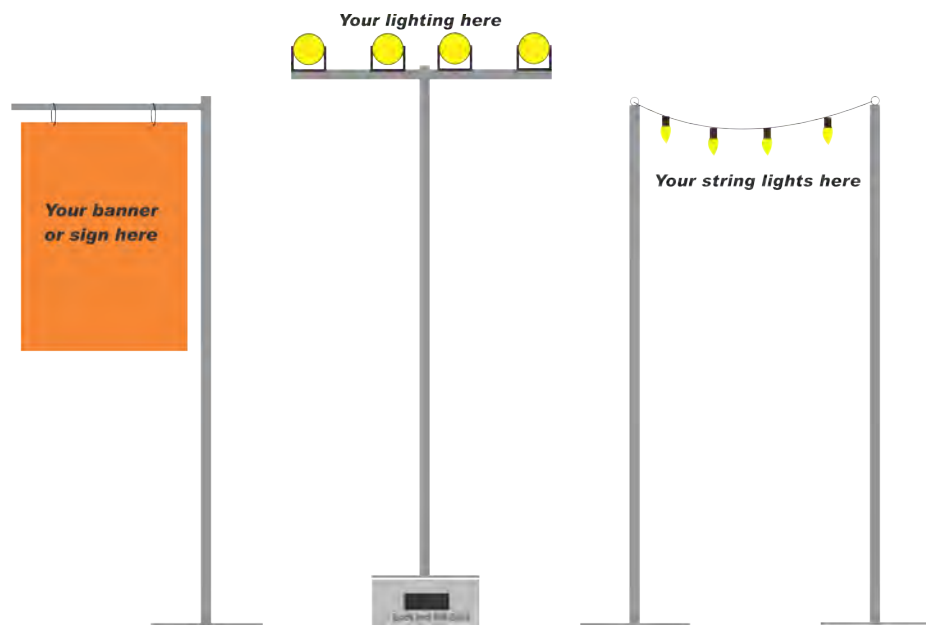

Specially designed U-Bolt to connect base plates to our blocks.



POLE AND BASE SYSTEM

This new versatile Pole and Base System allows for many different configurations. Use indoors with its 50lb base or attach it to your Block And Roll® Blocks for added weight outdoors. Different pole attachments added to 6' or 8' poles can make sign banner holders, lighting "T" Bar stands, string light posts, portable fan mounts, radiant heater stands and more.



Pole Base 8 Mounted to Block



Pole Base 8B
Accepts Standard 1.5" black pipe

PLATES AND MOUNTS

POLE BASE 20 - 50lb steel pole base with 4 stake holes and 4 hole truss pattern mount. Can be used freestanding or mounted to block



Pole Base 20 Mounted to Block



Sign Post Mount



Pole Base 20B
Accepts Standard 1.5" black pipe

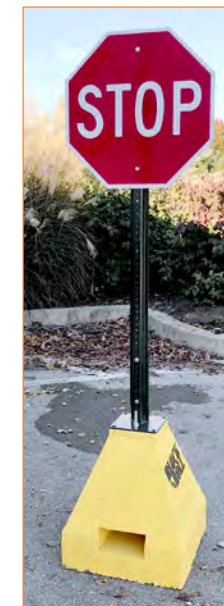

SIGN POST BLOCK

Pre-Made 375lb+/- tapered sign block includes loop on top for adding pole or post mount accessory (sold separately) Block comes in raw concrete but can be painted safety yellow for an additional cost. Form insert fits our standard block form. Dimensions: 20"x20"x22" High. Patent Pending

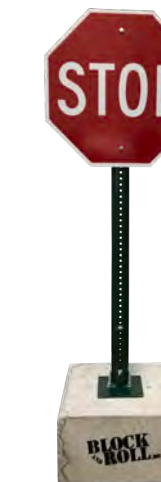

SIGN POST MOUNT

Our sign post mount bolts on to our blocks for attaching standard "U" channel sign post. Use this for Stop signs, directional signs, etc. Patent Pending



SOLAR LIGHT

Self contained Solar Lights feature auto dusk to dawn and auto dim function with motion detection. Use with our block post system or traditional light mounting poles. Available in 50W-150W. Perfect for remote location with no access to power.



POLE AND BASE SYSTEM ACCESSORIES



L-Pole with Lower Clamp on Banner Pole shown.



String Light Adapter with Eye 24" & 48"



T-Bar



24" Extension Pole Adapter



Clamp on Banner Pole



Clamp on Banner Pole



TRUSS MOUNT OPTIONS

Create Weighted Stands for 12x12 or 20.5x20.5 truss



Custom pole configurations available.

BLOCK LEVEL PLATE

The 4 block Level Plate is designed to work with our 4 Block Truss/Post Mount to level the blocks on uneven ground. Includes 4 Screw Jacks



4 BLOCK TRUSS/POST MOUNT

Join 4 blocks together with this Truss/Post mount to create truss towers or post towers. Hole patterns for 12x12 and 20.5x20.5 Truss. Custom posts available. Works with 350-700lb blocks. Shown with optional Level Plate with screw jacks.



TABLE POLE MOUNT

Add a table to your Pole and Base system. Great for making use of String light poles or use with our Tiki Umbrella system. Table top not included. 36" max table recommended.



FAN POLE ADAPTER 48"

Add this 48" Fan Pole to your existing Pole and Base System to create standing Fans. Will work with most fans. Sample picture shown with 24" fan. (fan and base not included)



RADIANT HEATER

The heavy-duty Wall Mounted Infrared Patio Heater introduces a new revolution in outdoor heating. Operating at 90% heating efficiency, this infrared patio heater runs on regular household electric current and is substantially less expensive to operate than propane patio heaters. This adaptable unit can be used indoors and outdoors and comes with a movable mounting bracket. Heaters work great mounted to tent poles or our Pole and Base system.



Shown Mounted to our Pole & Base T-Bar

UMBRELLA POLE

Add this 36" Umbrella Pole to your existing pole and base system to create free standing wind resistant umbrella bases. Use with our Hand Sanitizing Brackets to create an outdoor sanitizing station.



PROPANE BRACKET + KIT

Our Propane Tank/Cylinder Bracket connects to any 2" post to safely store tanks and keep them from tipping over Code officials require propane tanks to be anchored and our bracket allows you to secure up to 2 - 100lb propane tanks at once. Supplement this with any B&R Pole and Base pole, base, and block as seen in the picture, for a safe and efficient way to stay up to code and heat your tents safely. Mounts can also be staked into grass when staking is available. (Stakes not included)



UNIVERSAL STRUCTURE TENT LIGHTING CLAMP

Trac Clamp offers a tool free solution for hanging lights and more in tents with Keder Trac. Featuring a universal fit for beams 38mm to 120mm.



TENSION TENT LIGHT BRACKET

Our Lace-Point Bracket will allow you to hang a Chandelier, Hanging light, Paper Lantern or any other light weight item from your lace line in your pole or tension tent. Includes hanging cable. Aluminum construction with white powder coating. 30lb limit. Fits most sailcloth lace-together tops.

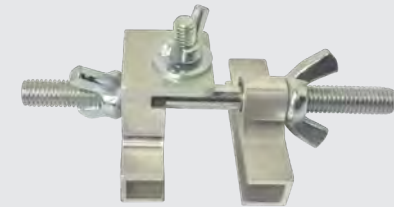
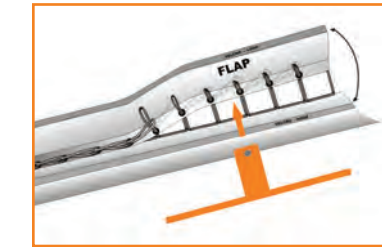

TRAC CLAMP "S" PLUS

Trac Clamp "S" offers a solution for single point hanging. Great with light fixtures, fans, fire extinguisher, fabric and just about anything else up to . 75lb Rating.

TRAC CLAMP "T" PLUS

Our Trac Clamp "T" offers a universal solution for hanging lights and other items in tents with Keder track, 150lb Rating.

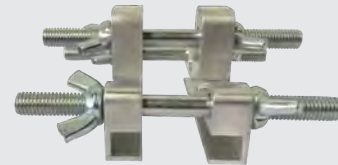

TRAC CLAMP "R" PLUS

Trac Clamp "R" is for rigging truss or larger items in your structures. 500lb Rating.



FIRE EXTINGUISHER BRACKET

Clamp on Fire Extinguisher bracket fits most round tent poles up to 2.5" OD.



LED LIGHTS

LED High Bay and Flood Lights feature the latest in LED technology and instant on function. Fixtures available with 50W to 320W LED bulbs which allow for tremendous power savings on your job sites.

100W LED HIGH BAY LIGHT

Bulbs 1040 LEDs
Luminous Flux: 13500LM
Rated voltage 100-300VAC
Amp: 1.1 on 110V
Rated Wattage: 113w
Color Temp CW(6000-6500K)
Beam Angle 360, 50,000 Hours
CE ROHS Approved
UL listed bulb
Non-Dimmable

150W HIGH BAY FIXTURE

Color Temp: 150w High Bay Fixture (Black or White)
Technical Specifications
Model: HBB-150 Rated Power: 150w
Input Voltage: AC100-265
Amp: 1.4 on 110V
LED Chip: Phillips 3030
Driver: Meanwell
Color Temp: 5500k+/-
Lumin Flux: 130lm/w Beam Angle: 120°
Lifespan(hrs): 50,000 Hours
IP grade: IP65 Weight: 9lbs
Working Environment: Temp -4°F Humidity 5-95% R.H.
Certification: UL, cUL,PSE CE,DLC



PORTABLE EXIT EMERGENCY COMBO LIGHT WITH CASE

Porta-Exit offers a true portable solution for Exit/Emergency Light Combo units. The built-in LED strip takes the place of side mounted lights. Our all LED unit features long lasting NiCad Batteries, an exterior battery interrupt switch (no need to open unit to disconnect batteries), and universal hanging lanyards. This ultra compact unit also features a foam lined transport case.

2 HEAD EMERGENCY LIGHT WITH CASE



2 Head emergency lights are designed just like our Port-Exit line of Exit Lights. These portable fixtures are ready to use and plug in. The all LED unit features long lasting NiCad Batteries, an exterior battery interrupt switch (no need to open unit to disconnect batteries), and universal hanging lanyards.



RUNNING MAN/CANADA PORTABLE EXIT LIGHT COMBO

Porta-Exit RM offers a true portable solution for Exit/Emergency light Combo units for Canada and other international locations. Exit light housing and internal electronics is Certified cSA. The built-in LED strip takes the place of side mounted lights. Our all LED unit features long lasting NiCad Batteries, an exterior battery interrupt switch (no need to open unit to disconnect batteries), and universal hanging lanyards. This ultra compact unit also features a foam lined transport case, Includes 3 Running man inserts; centered, left arrow and right arrow.



Includes: Battery interrupt switch & universal hanging lanyards.

BLOCK HOIST/STAKE BLOCK COMBO

Pull stakes using a forklift, skid-steer, or any other machine with forks.



6000LB MAX WORKING LOAD

BLOCK HOIST W/HOOK



STAKE BLOCK



TABLE LEG EXTENDER

Extend most rental table legs by 6". Aluminum construction. Includes set screw. Set of 4.



LIFTING SLING

This lifting sling is perfect for raising arches on clear span structures and lift up tents. The sling features 2 loops, one for a snug fit on one fork and one with a larger loop for easy removal while up in the air after beam is secured. No need to climb a ladder to remove from the beam.



BLOCK AND ROLL MERCHANDISE / FREE GIFTS WWW.BLOCKANDROLL.COM

Shop our website and get free shipping on orders over \$100.00 for all non-freight items. Check your Shopping Cart for some of these free gifts.

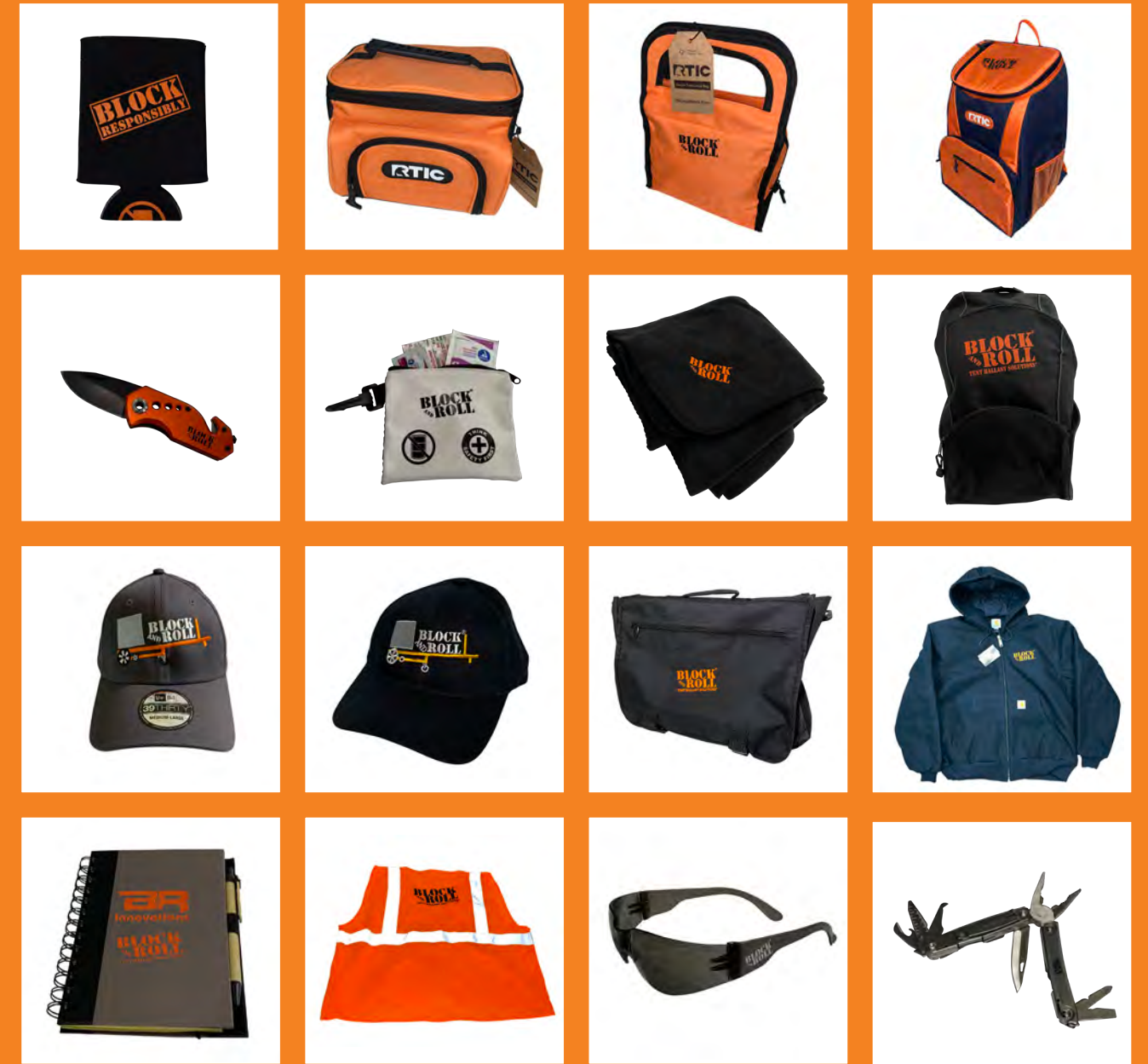

CONSUMABLES

TENT CREW SAFETY VEST YELLOW/LIME (M-4X)

LIST PRICE	SHOW PRICE	QTY.
\$14.99	\$13.50	

HOOK & LOOP TAPE

PSA 1"X25YD WHITE HOOK ROLL	\$22.75	\$20.48	
PSA 1"X25YD WHITE LOOP ROLL	\$22.75	\$20.48	
PSA 2"X25YD WHITE HOOK ROLL	\$48.00	\$43.20	
PSA 2"X25YD WHITE LOOP ROLL	\$48.00	\$43.20	

PINS

TENT PIN 3/8" X 1-1/8" WITH BALL AND PULL RING	\$1.79	\$1.61	
TENT PIN 3/8" X 2" WITH BALL AND PULL RING	\$1.58	\$1.42	
TENT PIN 3/8" X 2-5/8" WITH BALL AND PULL RING	\$2.49	\$2.24	
TENT BAIL PIN 3/8" X 2-3/4" (2-1/2" USABLE) SQUARE LOCK	\$1.99	\$1.79	
R-PIN/HITCH PIN. CADMIUM PLATED, OIL TEMPERED SPRING STEEL	\$0.35	\$0.32	
3-1/2" HINGE PIN 2.75" USABLE SPACE, ZINC/GOLD	\$1.29	\$1.16	
QUICK PIN FOR UP TO 1.75" ROUND TUBE	\$0.89	\$0.80	

**B&R INNOVATIONS, LLC**

888-998-5739

WWW.BLOCKANDROLL.COM

PRICE LIST ARA 2021

Pricing good for 30 days Due to Current Supply Chain Climate

BLOCK MOVING EQUIPMENT

	LIST PRICE	SHOW PRICE	QTY.
BLOCK AND ROLL STARTER KIT (1) Mover Cart, (1) Multi Block Form 700 Kit, (25) Front Hooks, (25) Top Hooks, (1) Carry All	\$2,389.00	\$2,269.55	
BLOCK AND ROLL STARTER KIT OFF ROAD EDITION (1) Mover Cart Off Road Edition, (1) Multi Block Form 700 Kit, (25) Front Hooks, (25) Top Hooks, (1) Carry All	\$2,839.00	\$2,697.05	
MOVER CART STANDARD	\$1,350.00	\$1,282.50	
MOVER CART OFF ROAD EDITION	\$1,699.00	\$1,614.05	
MOVER CART 350	\$950.00	\$902.50	
E-MOVER 2.0 MOTORIZED MOVER CART	\$3,295.00	\$3,130.25	
CB STACKER (MANUAL WINCH) *Available with 12V Winch - \$600 additional	\$1,849.00	\$1,756.55	
ATV EXT CART/STACKER	\$3,349.00	\$3,181.55	
CARRY ALL LOAD BRACKET	\$99.00	\$94.05	
EZ-STACK 350 (350lb Block Stacking Accessory)	\$125.00	\$118.75	
EZ-STACK 350 'T' WITH 2" TRAILER BALL	\$145.00	\$137.75	
OFF ROAD ACCESSORY KIT (For Existing Mover Cart)	\$449.00	\$426.55	

STEEL BLOCK FORMS

MULTI BLOCK FORM 700 KIT	\$925.00	\$878.75	
MULTI BLOCK FORM 700 KIT WITH HIGH DENSITY PLASTIC FORM BASE	\$1,005.00	\$954.75	
HALF BLOCK FORM 1750 KIT	\$1,799.00	\$1,804.05	
BIG BLOCK FORM 3500 KIT	\$1,899.00	\$1,709.10	

BLOCK FORM ACCESSORIES

B&R SQ 4" KNOCKOUT FOR FRONT HOOK	\$39.80	\$37.81	
B&R RD 5" KNOCKOUT FOR TOP HOOK	\$39.80	\$37.81	
B&R TOP TIE OFF HOOK (350-700 LB)	\$5.99	\$5.69	
B&R FRONT TIE OFF HOOK (350-700 LB)	\$5.99	\$5.69	
B&R BIG BLOCK FRONT AND TOP TIE HOOK (1750-3500 LB)	\$6.99	\$6.64	
HIGH DENSITY PLASTIC FORM 700 BASE	\$99.99	\$94.05	
CUSTOM LOGO BLOCK STAMP	\$169.00	\$160.55	

**ORDERS MUST BE PLACED AT THE SHOW & CONFIRMED BY
NOVEMBER 19th 2021**

Pricing good for 30 days only due to current supply chain climate

CUSTOMER INFORMATION

COMPANY NAME _____

CONTACT NAME _____

PHONE NUMBER _____

EMAIL ADDRESS _____



B&R INNOVATIONS, LLC
 888-998-5739
 WWW.BLOCKANDROLL.COM

PRE-MADE BLOCKS BUY MORE, SAVE MORE!

BLOCKS MAY VARY IN WEIGHT DUE TO CONSISTENCY OF CONCRETE

	LIST PRICE	SHOW PRICE	QTY.
350+/- LB BLOCK (20X20X12"H) \$99 WITH 75 MIN OR FULL TRUCK LOAD!	\$129.00	\$116.10	
500 +/- LB BLOCK (20X20X16.5"H) \$109 WITH 75 MIN OR FULL TRUCK LOAD	\$139.00	\$125.10	
700+/- LB BLOCK (20X20X22"H) \$129 WITH 75 MIN OR FULL TRUCK LOAD	\$149.00	\$134.10	
1750+/- LB BLOCK (20X20X29"H) *FORKLIFT ONLY*	\$279.00	\$265.05	
3500+/- LB BLOCK (40X40X29.5"H) *FORKLIFT ONLY*	\$325.00	\$308.75	
RUBBER BLOCK MAT (20"X20")	\$6.99	\$6.29	

BLOCK PLATES & ACCESSORIES

"S" PLATES HAVE MOUNTING PLATE FOR STRUCTURE BASE PLATE WITH 4 HOLES DRILLED TO YOUR SPECIFICATION

2 BLOCK PLATE "S" (Structure)	\$899.00	\$854.05	
4 BLOCK PLATE "S" (Structure)	\$999.00	\$899.10	
STEEL BLOCK PLATE (Single)	\$1275.00	\$1211.25	
STEEL BLOCK PLATE (double)	\$1575.00	\$1496.25	
UNIVERSAL BLOCK PLATE "S" (Structure) *Fits Standard Landscape Blocks*	\$999.00	\$949.05	
4 BLOCK PLATE TRUSS MOUNT	\$579.00	\$550.05	
4 BLOCK LEVEL PLATE WITH SCREW JACKS	\$649.00	\$616.55	

VINYL BLOCK COVERS

350 WHITE VINYL BLOCK COVER	\$35.00	\$31.00	
500 WHITE VINYL BLOCK COVER	\$39.00	\$35.10	
700 WHITE VINYL BLOCK COVER	\$42.00	\$37.80	
3500 WHITE VINYL BLOCK COVER	\$75.00	\$67.50	

BLOCK HOIST/STAKE BLOCK

BLOCK HOIST HOOK	\$259.00	\$224.10	
STAKE BLOCK	\$129.00	\$116.10	
STAKE BLOCK/BLOCK HOIST COMBO	\$397.99	\$358.19	

POLE AND BASE

	LIST PRICE	SHOW PRICE	QTY.
POLE BASE 20 (50 lb Steel Base with Pole Mount)	\$259.00	\$246.05	
POLE BASE 20B WITH1-1/2"BLACK PIPE ADAPTER	\$259.00	\$246.05	
POLE BASE 8 (Mount Only)	\$129.00	\$122.55	
POLE BASE 8BWITH1-1/2"BLACK PIPE ADAPTER	\$189.00	\$179.55	
8' POLE	\$95.00	\$90.25	
6' POLE	\$89.00	\$56.05	
STRING LIGHT ADAPTER POLE 24" WITH EYEBOLT	\$75.00	\$71.25	
STRING LIGHT ADAPTER POLE 48" WITH EYEBOLT	\$85.00	\$80.75	
BANNER "L" POLE ADAPTER	\$99.00	\$94.05	
LIGHTING "T" BAR ADAPTER	\$139.00	\$132.05	
24" EXTENSION POLE ATTACHMENT	\$65.00	\$61.75	
48" FAN POLE /PROPANE TANK POLE	\$99.00	\$94.05	
36" UMBRELLA POLE	\$89.00	\$84.55	
CLAMP ON BANNER POLE (2" Clamp with 34" Pole)	\$54.00	\$51.30	
SIGN POST BLOCK MOUNT (Green)	\$99.00	\$94.50	
DUAL PROPANE TANK/CYLINDER BLOCK MOUNT KIT	\$287.00	\$272.65	
DUAL PROPANE TANK/CYLINDER BRACKET (Post Mount Bracket Only)	\$99.00	\$94.05	
TABLE LEG EXTENSION 12" (Set of 4)	\$75.00	\$71.25	
LED LIGHTS *Clamps for Lights are Not Included *			
LED HIGH BAY LIGHT 100W (Cool White / 6000 - 6500K)	\$279.00	\$251.11	
LED HIGH BAY WORK LIGHT 100W (Cool White)	\$259.00	\$233.10	
HBB-2 LED HIGH BAY 150W (Black / White Fixtures)	\$249.00	\$224.10	
LE2-50S FLOOD LIGHT 50W (Silver Fixture)	\$99.00	\$89.10	
PORTA EXIT/EMERGENCY LIGHTS			
PORTA EXIT "SLIM COMBO" EXIT LIGHT WITH CASE	\$240.50	\$228.00	
PORTA EXIT "SLIM COMBO" EXIT LIGHT WITH CASE (BLACK)	\$245.50	\$232.75	
RUNNING MAN/CANADA PORTABLE EXIT LIGHT COMBO WITH CASE	\$259.00	\$246.05	
2-HEAD LED EMERGENCY LIGHT	\$99.95	\$94.05	
TENT CLAMP			
TRAC CLAMP 'S' PLUS (75 lb Capacity)	\$54.99	\$49.49	
TRAC CLAMP 'R' PLUS (500 lb Capacity)	\$149.00	\$134.10	
TRAC CLAMP 'T' WITH 4' ROUND PIPE 2" DIAMETER (150 lb Capacity)	\$149.00	\$134.10	
FIRE EXTINGUISHER CLAMP FE2C (Fits up to 2.5" tent legs)	\$19.95	\$17.95	
LAC-POINT TENSION TENT BRACKET WITH 30" STEEL CABLE (SC)	\$39.00	\$35.10	